

North Valley Homes

Building Relationships One Home At a Time

2001 46th Ave SE
Mandan, ND 58554

www.northvalleynd.com

(701)663-4009

"Dakota" Maixner
701-391-1526
dkotahm@gmail.com

"Dakota" Maixner
701-391-1526
dkotahm@gmail.com

MC MULBERRY

Sales Lot #1

3 bedroom, 2 bathroom

28'X60' 1600 square feet

Type: Manufactured
Builder: Midcountry Homes

Year: 2018
Model: 3W1021-P
Serial #: 10381 & 10593

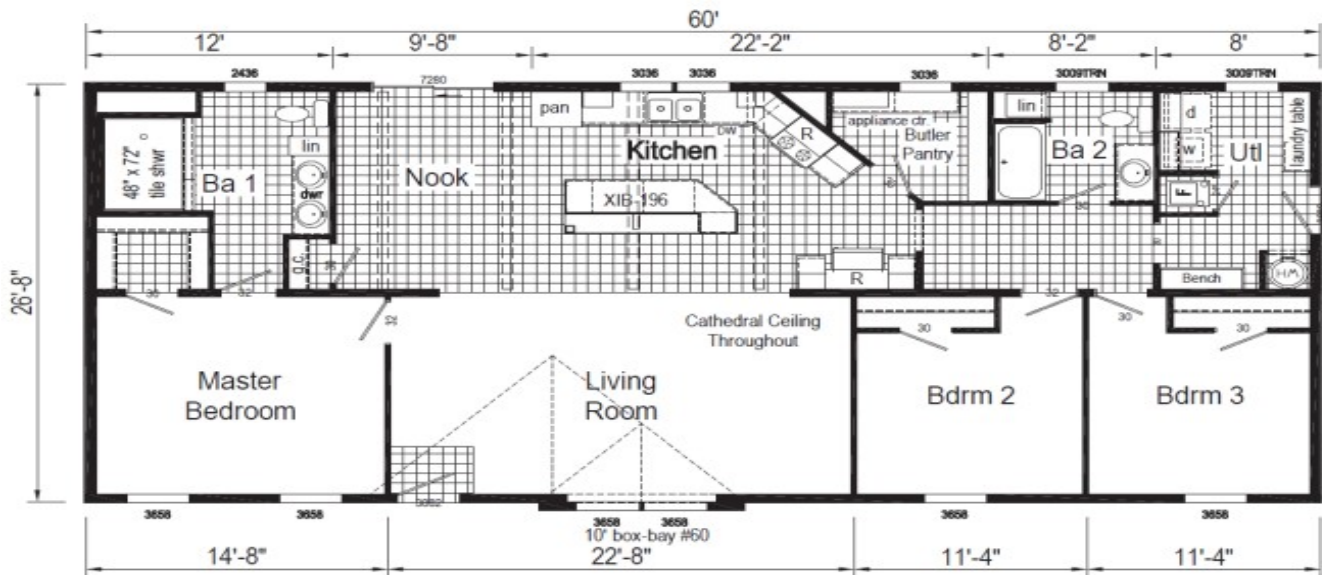

LOT MODEL SALE PRICE:

\$115,545.00

**All
Inclusive**

ORDER-IN PRICE:

\$130,200.00

**All
Inclusive**

Price of home as shown, with setup & delivery (details above)

North Valley Homes

Building Relationships One Home At a Time

2001 46th Ave SE
Mandan, ND 58554

www.northvalleynd.com

(701)663-4009

"Dakota" Maixner
701-391-1526
dkotahm@gmail.com

"Dakota" Maixner
701-391-1526
dkotahm@gmail.com

MC MULBERRY

Sales Lot #1

MANUFACTURED Price includes :

Base price of home **\$86,212.00**

Includes Delivery

Exterior finish **\$16,500.00**

Drill and pour concrete - Piers	\$4,300.00
2 doors 4x4 Deck & Steps	\$700.00
Insulated / installed w/ auto vents - Ski	\$3,520.00
Basic set up:	\$7,980.00
Set home (block, anchor, level)	
Side home	
All hook ups except electric and gas (Must have water and sewer run to the location)	
Heat tape on the water line	
Vapor barrier under the home	
NDMHA State Inspections for Manufactured Homes	
ND Use Tax (no sales applies)	

Central Air installed **\$2,500.00**

Interior finish completed **\$4,000.00**

- All drywall cracks and opening finishes
- Touch up paint
- Caulking all back splashes
- All floor coverings completed
- Interior doors installed and adjusted

Construction clean

Optional upgrades (See Options sheet) **\$20,988.00**

Order-In Pricing (All Inclusive) \$130,200.00

Lot Model Pricing (All Inclusive) \$115,545.00

North Valley Homes

Building Relationships One Home At a Time

2001 46th Ave SE
Mandan, ND 58554

www.northvalleynd.com

(701)663-4009

"Dakota" Maixner
701-391-1526
dkotahm@gmail.com

"Dakota" Maixner
701-391-1526
dkotahm@gmail.com

MC MULBERRY

Sales Lot #1

UPGRADE OPTIONS

THESE MAY BE ADDED TO THE BASE PRICE TO ENHANCE YOUR HOME

INFORMATION

- 1 HUD CODE
- 1 WARRANTY 10-YR LTD STRUCTURAL

Cost	Select	Addl Cost
\$0.00	<input type="text"/>	
\$150.00	<input type="text"/>	

FRAMES/FLOORS

- 1 MANTRA/ IT'S COZY STANDARD
- CARPET COLOR-- IT'S COZY- WOODSMOKE; LINOLEUM COLOR-- LX276

\$0.00	<input type="text"/>	
--------	----------------------	--

PLUMBING/HEATING

- 1 FRN 95 PLUS M7RL072ABW 60' & OVER
- 1 HEAT PERIMETER
- 1 WATER HEATER 50 GAL ELEC INSTALLED W/PAN
- 1 FAUCET EXTERIOR WATER EXTRA (DS-ODS)
- 1 FAUCET HUNTINGTON KIT GOOSENECK W/ PULL DOWN- NICKEL
- 3 FAUCET HUNTINGTON LAV- NICKEL(AT ALL BATH SINKS)
- 2 FAUCET HUNTINGTON ANTI-SCALD-NICKEL (TUB/SHWR)
- 1 KITCHEN SINK-SS DOUBLE BOWL 33X22X8
- 1 SHUT OFF VALVES @SINKS & TOILETS T/O

\$690.00	<input type="text"/>	
\$300.00	<input type="text"/>	
\$234.00	<input type="text"/>	
\$54.00	<input type="text"/>	
\$180.00	<input type="text"/>	
\$162.00	<input type="text"/>	
\$108.00	<input type="text"/>	
\$0.00	<input type="text"/>	
\$96.00	<input type="text"/>	

DOORS/WINDOWS

- 1 DOOR STEEL LEADED GLASS 38X82
- 1 DOOR SLIDING GLASS VINYL W/VERT BLIND REP 1 WDW- NOOK
- 1 WINDOW VINYL 24X36-BA1
- 2 WINDOW TRANSOM 30X9--BA2 AND UTRM
- 1 BAY WINDOW #60 REP (2) WDWS
- 1 DOOR 9-LITE STEEL REP STD RR

\$450.00	<input type="text"/>	
\$810.00	<input type="text"/>	
\$210.00	<input type="text"/>	
\$252.00	<input type="text"/>	
\$480.00	<input type="text"/>	
\$90.00	<input type="text"/>	

WALLS/INSULATION

- 1 INSULATION CEILING R-38 BLOWN
- 1 INSULATION FLOOR R-22
- 1 INSULATION R21 INSULATION HIGH DENSITY REP R19 PER LF
- 1 INTERIOR WALLS 2X3- 24" OC
- 1 CEILING HEIGHT 8'0"

\$216.00	<input type="text"/>	
\$432.00	<input type="text"/>	
\$360.00	<input type="text"/>	
\$0.00	<input type="text"/>	
\$0.00	<input type="text"/>	

EXTERIOR

- COLORS-
- SIDING & TRIM- CLAY
- SHAKE SIDING- BLACK WALNUT
- 1 LINEALS STANDARD FRON & DOORSIDE- (COLOR-CLAY)
- 1 ROOF PITCH FIXED CATHEDRAL
- SECTIONALS INCLUDE LUAN ON MARRIAGE WALL
- 1 SHINGLES ARCHITECTURAL- (COLOR- DRIFTWOOD)
- 1 12' EAVES
- 1 DORMER 18'8" TWIN PEAK-FIXED
- 10 SHAKE ACCENT SIDEWALL PER LF
- 1 CLAY PACKAGE
- CLAY VINYL WDWS, FRT/REAR CLAY DOORS
- CLAY SOFFIT/FACIA/TRIM EXTERIOR LIGHTS PER SPEC
- 1 WIND WRAP

\$0.00	<input type="text"/>	
\$900.00	<input type="text"/>	
\$834.00	<input type="text"/>	
\$0.00	<input type="text"/>	
\$690.00	<input type="text"/>	
\$240.00	<input type="text"/>	
\$534.00	<input type="text"/>	
\$180.00	<input type="text"/>	

ELECTRICAL

1 200 AMP SERVICE	\$114.00	
1 2ND CONDUIT FROM PANEL BOX	\$30.00	
1 PADDLE FAN WHITE DELUXE-LR	\$222.00	
1 TV JACK-LR	\$48.00	
1 USB RECEPT. STD.-KITCH	\$0.00	
1 TELEPHONE JACK-KITCH	\$48.00	
1 WIRE & SUPPORT FOR PADDLE FAN-MBR	\$66.00	
3 LIGHT CEILING-EXTRA (ALL BR'S)	\$0.00	
6 LIGHT LED FLUSH MOUNT-KITCH	\$468.00	
1 RECEPTACLE EXTERIOR-EXTRA (DS-ODS)	\$54.00	
1 CARBON MONOXIDE DETECTOR	\$114.00	
1 THERMOSTAT PROGRAMMABLE	\$0.00	
1 FRONT EXTERIOR PATINA COACH LIGHT	\$0.00	

APPLIANCES

1 REFER FRIGIDAIRE 23 CF SXS W/WATER & ICEMAKER-SS	\$0.00	
1 RANGE FRIGIDAIRE SMOOTH TOP ELEC REP STD-SS	\$0.00	
1 DISHWASHER FRIGIDAIRE TALL TUB- SS	\$0.00	
1 MICROWAVE OVER-RANGE FRIGIDAIRE REP RANGE HOOD- SS	\$330.00	
1 GARBAGE DISPOSAL INSTALLED	\$120.00	
1 WASHER ELECTRIC INSTALLED	\$570.00	
1 DRYER ELECTRIC INSTALLED	\$582.00	
GOLD PLUS PKG- STAINLESS GAS	\$1,950.00	

CABINETS/CERAMIC

COLORS-

KIT, ISLAND, B. PANTRY, BA1, BA2, UTILITY & ACCENT CABS--

BARNWOOD OAK MISSION FLAT PANEL

KIT, ISLAND, & B. PANTRY C-TOP-- AUTUMN CARNIVAL

BA1 C-TOP-- WINTER CARNIVAL

BA2, UTILITY, & BENCH C-TOP-- HENNA VESTA

BA2 & UTILITY BACKSPLASH-- MATCHES LAMINATE

BENCH CABINETS-- MESSINA OAK MISSION FLAT PANEL

1 BARN WOOD OAK CABINETS T/O	\$0.00	
1 ISLAND XIB-196 41X101	\$1,794.00	
1 BACKSPLASH SKYBRIDGE 4X8 SINGLE ROW-KITCHEN (COLOR-GRAY)	\$288.00	
1 BACKSPLASH MARBRE 4X12 SINGLE ROW-BATH (COLOR-GRAY)	\$240.00	

INTERIOR

COLORS-

TILE SHOWER-- GREY W/ TRITAN GLASS MOSAIC

1 CABINET 30" & WIRE SHELF OVER LNDRY, MO-203A	\$180.00	
--	----------	--

1 BOOT BENCH IN UTL ROOM 48"	\$270.00	
------------------------------	----------	--

1 SHWR CERAMIC 4'X6' WALK-IN REP TUB/SHWR	\$2,994.00	
---	------------	--

RAINFALL & ADJUSTABLE SHWR HEAD;(2) RECESSED LED LIGHT

1 DOUBLE LAVS-BA1	\$162.00	
-------------------	----------	--

1 OIL RUBBED BRONZE INTERIOR PKG	\$270.00	
----------------------------------	----------	--

INCLUDES: LIGHTING, DOOR & CABINET HARDWARE

CURVED SHWR ROD DOESN'T INCLUDE EXT DOOR HARDWARE OR FAUCETS

1 WALLS-ORANGE PEEL	\$0.00	
---------------------	--------	--

1 STANDARD WHITE MOULDING PKG	\$0.00	
-------------------------------	--------	--

4 CEILING BEAMS, EA. (KIT/NOOK)	\$696.00	
---------------------------------	----------	--

120 PLANK BOARD PER S.F.- LIVRM WALL	\$576.00	
--------------------------------------	----------	--

1 DRAWER BANK IN LAV CABINET- BA1	\$150.00	
-----------------------------------	----------	--

\$20,988.00

\$0.00

North Valley Homes

Building Relationships One Home At a Time

2001 46th Ave SE
Mandan, ND 58554

www.northvalleynd.com

(701)663-4009

"Dakota" Maixner
701-391-1526
dkotahm@gmail.com

"Dakota" Maixner
701-391-1526
dkotahm@gmail.com

Advantages of MidCounty Homes

- Energy Star Certified
- KCMA Certified Cabinets
- Sheet rock and solid wood cabinets throughout
- 100 lb. Under mount soft close drawer guides
- Primed drywall throughout with orange peel finish, including ceiling
- Window valances and one inch mini blinds throughout
- Shower curtain and rounded rod
- Extra OSB sheathing on mate wall
- Copper wiring throughout
- 38" Fiberglass front and rear doors
- Front and rear doors with deadbolts
- Deep Stainless steel sink 33x22x8
- Hardwood cabinets and stiles throughout
- 2x6 exterior wall 16 inch OC
- Counters built by high end machine
- Built on laser leveled factory floor
- Electric boxes nailed to a stud
- Doors with mortise hinges
- High low cold air returns(where available)
- One piece fiberglass tubs
- Elongated toilets
- Anti-scald valves on showers and tubs
- Low E windows
- 36" high vanities in bathrooms
- ¾" adjustable shelves