

# North Valley Homes

*Building Relationships One Home At a Time*

2001 46th Ave SE  
Mandan, ND 58554

[www.northvalleynd.com](http://www.northvalleynd.com)

(701)663-4009

"Dakota" Maixner  
701-391-1526  
[dkotahm@gmail.com](mailto:dkotahm@gmail.com)

"Dakota" Maixner  
701-391-1526  
[dkotahm@gmail.com](mailto:dkotahm@gmail.com)

## BIG KAHUNA

### Sales Lot #8

4 bedroom, 2 bathroom

28'X76' 2027 square feet

Type: Manufactured  
Builder: Midcountry Homes

Year: 2019  
Model: 3W1034  
Serial #: 10383

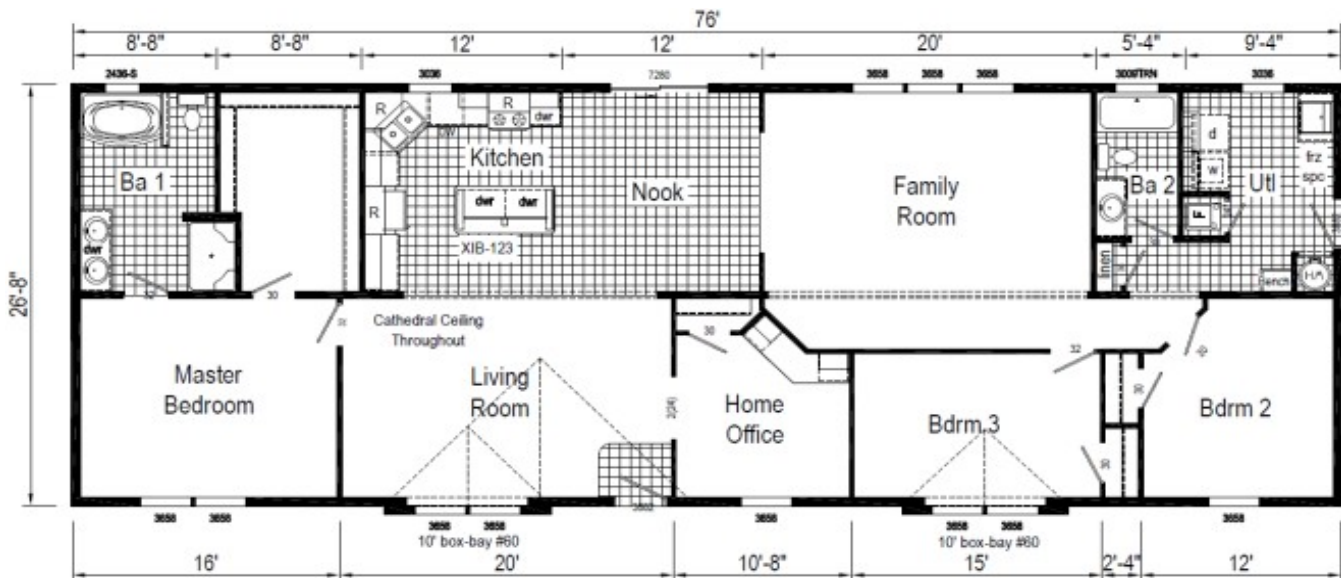

LOT MODEL SALE PRICE:

N/A

All  
Inclusive

ORDER-IN PRICE:

**\$144,961.75**

All  
Inclusive

Price of home as shown, with setup & delivery (details above)

# North Valley Homes

*Building Relationships One Home At a Time*

2001 46th Ave SE  
Mandan, ND 58554

[www.northvalleynd.com](http://www.northvalleynd.com)

(701)663-4009

"Dakota" Maixner  
701-391-1526  
dkotahm@gmail.com

"Dakota" Maixner  
701-391-1526  
dkotahm@gmail.com

## **BIG KAHUNA**

### **Sales Lot #8**

#### **MANUFACTURED** Price includes :

**Base price of home** **\$101,648.55**

Includes Delivery

**Exterior finish** **\$18,500.00**

Drill and pour concrete - Piers	\$5,200.00
2 doors 4x4 Deck & Steps	\$700.00
Insulated / installed w/ auto vents - Ski	\$4,120.00
Basic set up:	\$8,480.00
Set home (block, anchor, level)	
Side home	
All hook ups except electric and gas (Must have water and sewer run to the location)	
Heat tape on the water line	
Vapor barrier under the home	
NDMHA State Inspections for Manufactured Homes	
ND Use Tax (no sales applies)	

**Central Air installed** **\$2,500.00**

**Interior finish completed** **\$4,000.00**

- All drywall cracks and opening finishes
- Touch up paint
- Caulking all back splashes
- All floor coverings completed
- Interior doors installed and adjusted

**Construction clean**

**Optional upgrades (See Options sheet)** **\$18,313.20**

**Order-In Pricing (All Inclusive) \$144,961.75**

**Lot Model Pricing (All Inclusive) N/A**

# North Valley Homes

*Building Relationships One Home At a Time*

2001 46th Ave SE  
Mandan, ND 58554

www.northvalleynd.com

(701)663-4009

"Dakota" Maixner  
701-391-1526  
dkotahm@gmail.com

"Dakota" Maixner  
701-391-1526  
dkotahm@gmail.com

## BIG KAHUNA

### Sales Lot #8

#### UPGRADE OPTIONS

THESE MAY BE ADDED TO THE BASE PRICE TO ENHANCE YOUR HOME

#### INFORMATION

1 HUD CODE  
1 WARRANTY 10-YR LTD STRUCTURAL  
ENERGY STAR RANCH \$725 FREE

Cost	Select	Addl Cost
------	--------	-----------

\$0.00   
\$150.00

#### FRAMES/FLOORS

1 MANTRA/IT'S COZY STANDARD  
CARPET COLOR--IT'S COZY- SAWDUST; LINOLEUM COLOR-- LX245

\$0.00

#### PLUMBING/HEATING

1 FRN 95 PLUS M7RL060ABW 60' & OVER  
1 HEAT PERIMETER  
1 WATER HEATER 50 GAL ELEC INSTALLED W/ PAN  
1 FAUCET EXTERIOR WATER EXTRA (DS-ODS)  
1 FAUCET HUNTINGTON KIT HIGH RISE NICKEL  
3 FAUCET HUNTINGTON LAV- NICKEL  
2 FAUCET HUNTINGTON ANTI-SCALD- NICKEL (TUB/SHWR)  
1 FAUCET HUNTINGTON ANTI-SCALD- NICKEL GLAMOUR TUB  
1 KITCHEN SINK- SS DOUBLE BOWL 33X22X8  
1 SHUT OFF VALVES @SINKS & TOILETS T/O

\$690.00   
\$300.00   
\$234.00   
\$54.00   
\$102.00   
\$162.00   
\$108.00   
\$114.00   
\$0.00   
\$96.00

#### DOORS/WINDOWS

1 FRONT DOOR 6-PANEL FIBERGLASS, 38X82  
1 REAR DOOR 6-PANEL FIBERGLASS, 38X82  
1 MULLED 58" WINDOWS STD PER PLAN  
1 DOOR SLIDING GLASS VINYL W/VERT BLIND REP 1 WDW--NOOK  
1 WINDOW VINYL 24X36--BA1  
WINDOWS 30x36 -UTILITY  
2 WINDOW TRANSOM 30X9--BA2 & UT SIDEWALL  
2 BAY WINDOW #60 REP (2) WDWs--LR & BR3

\$0.00   
\$0.00   
\$0.00   
\$690.00   
\$210.00   
\$240.00   
\$126.00   
\$960.00

#### WALLS/INSULATION

1 INSULATION CEILING R-38 BLOWN  
1 INSULATION FLOOR R-22  
1 R-19 EXTERIOR WALL INSULATION  
1 INTERIOR WALLS 2X3-24" OC  
1 CEILING HEIGHT 8'0"  
1 MARRIAGE WALL UNDERLAY WITH LUAN

\$273.60   
\$0.00   
\$0.00   
\$0.00   
\$0.00   
\$0.00

#### EXTERIOR

COLORS-  
SIDING & TRIM-- CLAY  
SHAKE SIDING-- BLACK WALNUT  
1 LINEALS STANDARD FRONT & DOORSIDE (COLOR- CLAY)  
3 WINDOW LINEALS- PER WINDOW--EXTRA  
1 ROOF PITCH FIXED CATHEDRAL

\$0.00   
\$450.00   
\$900.00

SECTIONALS INCLUDE LUAN ON MARRIAGE WALL	
1 SHINGLES ARCHITECTURAL (COLOR-DRIFTWOOD)	\$834.00
1 DORMER FLUSH 10'-FIXED (BR3)	\$510.00
1 DORMER 18'8" TWIN PEAK- FIXED	\$690.00
10 SHAKE ACCENT SIDEWALL PER LF	\$480.00
1 CLAY PACKAGE	\$534.00
CLAY VINYL WDWS, FRT/REAR CLAY DOORS	
CLAY SOFFIT/FACIA/TRIM EXTERIOR LIGHTS PER SPEC	
1 WIND WRAP	\$180.00

### ELECTRICAL

1 200 AMP SERVICE	\$114.00
1 2ND CONDUIT FROM PANEL BOX	\$30.00
2 PADDLE FAN WHITE DELUXE (LR-FR)	\$444.00
1 TV JACK--FR	\$48.00
1 USB RECEPT. STD.	\$0.00
1 TELEPHONE JACK-KITCH	\$48.00
4 LIGHT CEILING-EXTRA (ALL BR'S & HOME OFFICE)	\$168.00
2 LIGHT STEM, EACH	\$108.00
5 LIGHT LED FLUSH MOUNT (KIT IPO STD, KEEP OWN SWITCH OVER SINK)	\$390.00
1 RECEPTACLE INTERIOR-EXTRA (UTILITY FREEZER SPACE)	\$42.00
1 RECEPTACLE EXTERIOR-EXTRA (DS-ODS)	\$54.00
1 CARBON MONOXIDE DETECTOR/SMOKE DETECTOR	\$150.00
1 THERMOSTAT PROGRAMMABLE	\$0.00
1 FRONT EXTERIOR PATINA COACH LIGHT & REAR	\$0.00

### APPLIANCES

1 REFER FRIGIDAIRE 23 CF SXS W/WATER & ICEMAKER-SS	\$0.00
1 RANGE FRIGIDAIRE SMOOTH TOP ELEC REP STD-SS	\$0.00
1 DISHWASHER FRIGIDAIRE TALL TUB-SS	\$0.00
1 MICROWAVE OVER-RANGE FRIGIDAIRE REP RANGE HOOD-SS	\$330.00
1 GARBAGE DISPOSAL INSTALLED	\$120.00
GOLD PLUS PKG- STAINLESS ELEC	\$1,950.00

### CABINETS/CERAMIC

#### COLORS-

KIT, ISLAND, BA1, BA2, UTILITY, & BENCH CABINETS-- BARNYARD OAK MISSION FLAT PANEL	
KIT & ISLAND C-TOP-- TYPHOON ICE	
BA1 C-TOP-- WINTER CARNIVAL	
BA2, UTILITY, & BENCH C-TOP-- SUMMER CARNIVAL	
BA1, BA2, & UTILITY BACKSPLASH-- MATCHES LAMINATE	
1 BARNYARD OAK CABINETS T/O	\$0.00
OFFICE GETS SAME CABS/ COUNTERS AS KIT BUT W/ LAMINATE BACKSPLASH	
1 MOULDING UNDER CABINET HARDWOOD KITCHEN	\$150.00
DRAWER GUIDES SOFT CLOSE	\$0.00
1 CONTEMPORARY CAB PULL REP. STD	\$90.00
1 ISLAND XIB-123 36X72	\$1,194.00
1 BACKSPLASH SKYBRIDGE 4X8 SINGLE ROW-KITCHEN (COLOR-GRAY)	\$237.60

### INTERIOR

1 CABINET 30" & WIRE SHELF OVER LNDRY, MO-203A	\$114.00
1 UTILITY SINK WITH CABINET PLANT MADE	\$474.00
1 BOOT BENCH IN UTL ROOM 36"--UTRM	\$174.00
1 BATH GLAMOUR	\$834.00
1 DOUBLE LAVS--BA1	\$162.00
3 DRAWER BANK IN LAV CABINET	\$450.00
1 BANK MBATH BTWN LAV'S, 2 BANKS IN ISLAND BASE, ONE EACH SIDE	
1 BRUSHED NICKEL INTERIOR PKG	\$0.00
1 WALLS-ORANGE PEEL	\$0.00
1 STANDARD WHITE MOULDING PKG	\$0.00
1 HOME OFFICE WITH DESK& CLOSET PER STD PRINT	\$840.00
1 DRYWALL ROUNDED CORNERS T/O	\$510.00

**\$18,313.20**

**\$0.00**

# North Valley Homes

*Building Relationships One Home At a Time*

2001 46th Ave SE  
Mandan, ND 58554

[www.northvalleynd.com](http://www.northvalleynd.com)

(701)663-4009

"Dakota" Maixner  
701-391-1526  
[dkotahm@gmail.com](mailto:dkotahm@gmail.com)

"Dakota" Maixner  
701-391-1526  
[dkotahm@gmail.com](mailto:dkotahm@gmail.com)

## *Advantages of MidCounty Homes*

- Energy Star Certified
- KCMA Certified Cabinets
- Sheet rock and solid wood cabinets throughout
- 100 lb. Under mount soft close drawer guides
- Primed drywall throughout with orange peel finish, including ceiling
- Window valances and one inch mini blinds throughout
- Shower curtain and rounded rod
- Extra OSB sheathing on mate wall
- Copper wiring throughout
- 38" Fiberglass front and rear doors
- Front and rear doors with deadbolts
- Deep Stainless steel sink 33x22x8
- Hardwood cabinets and stiles throughout
- 2x6 exterior wall 16 inch OC
- Counters built by high end machine
- Built on laser leveled factory floor
- Electric boxes nailed to a stud
- Doors with mortise hinges
- High low cold air returns(where available)
- One piece fiberglass tubs
- Elongated toilets
- Anti-scald valves on showers and tubs
- Low E windows
- 36" high vanities in bathrooms
- ¾" adjustable shelves